

**The Chairman and Members of
North West Area Committee.**

Development Department
Civic Offices

Meeting: 15th November 2016

Item No: 27

With reference to the proposed disposal of site for a substation at Shangan Green, Ballymun, Dublin 9.

As part of the regeneration of Ballymun new housing developments were constructed at Shangan, Ballymun, Dublin 9. In order to service these developments it was necessary to provide ESB substations. One such substation, located at Shangan Green, is located on land in the ownership of Dublin City Council.

In accordance with the standard terms and conditions for the provision of an electricity supply, the City Council is required to provide sites for substations free of charge to the ESB. The site in question is shown outlined red and coloured pink on attached Map Index No.SM-2015-1019.

It is therefore proposed to dispose of the City Council's interest in this site in fee simple to the ESB subject to the following terms and conditions:

1. The site will be transferred to the ESB free of charge.
2. The E.S.B will pay a contribution of €750 (seven hundred and fifty euro) towards the City Council's legal costs incurred in the transaction together with VAT and reasonable outlay.

The disposal shall be subject to such conditions as to title to be furnished as the Law Agent in his discretion shall stipulate.

The dates for the performance of any of the requirements of the proposed agreement may be amended at the absolute discretion of the Executive Manager.

No agreement enforceable at law is created or intended to be created until an exchange of contracts has taken place.

Paul Clegg
Executive Manager

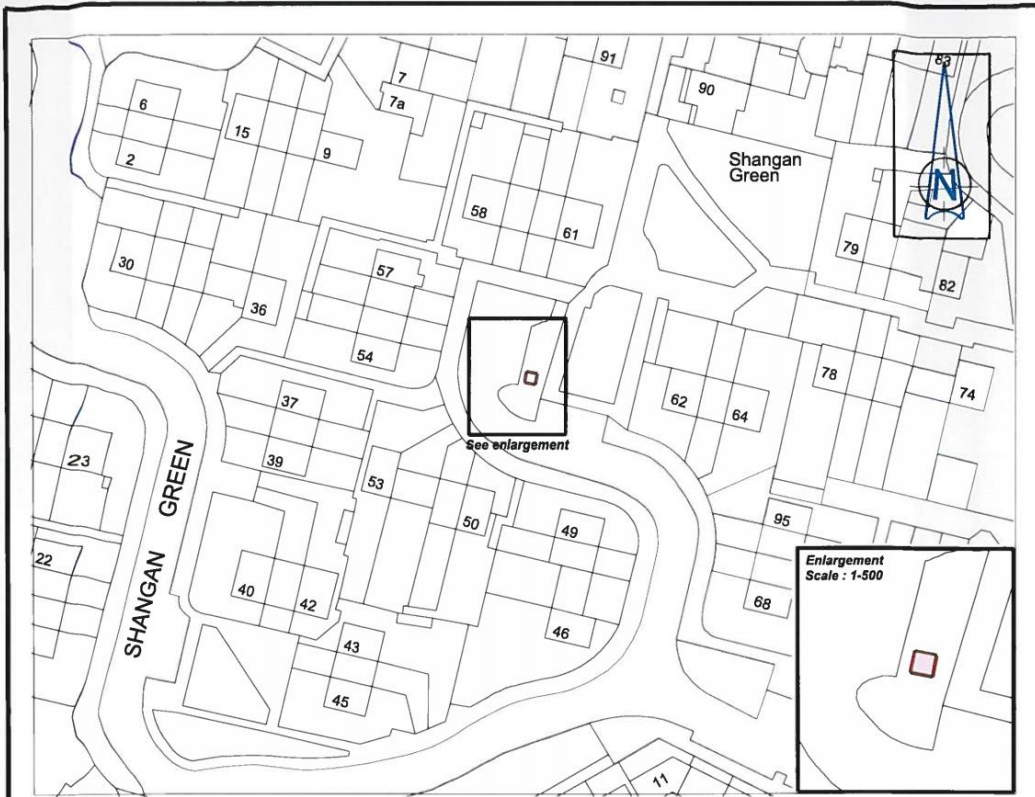

SHANGAN GREEN, BALLYMUN, DUBLIN 11 - ESB SUBSTATION

Dublin City Council to Electricity Supply Board

Proposed disposal of freehold interest

MAP FOR AREA COMMITTEE

Area 4.5 sq.m. approx.



Comhairle Cathrach
Bhaile Átha Cliath
Dublin City Council

An Roinn Comhshaoil agus Iompair
Rannán Suirbhéireachta agus Léarscáilthe
Environment and Transportation Department
Survey and Mapping Division

| | |
|---------------------------|--|
| O.S REF 3131-09 | SCALE 1-1000, 1-500 |
| DATE 11-01-2016 | SURVEYED / PRODUCED BY PMcGinn |

| | | | | |
|-----------------|-------------------------------------|-------------|---------------|------------|
| INDEX No | FOLDER No | CODE | DWG No | REV |
| FILE NO | SM-2015-1019_0204- C3 - 001 - A.dgn | | | |

THIS MAP IS CERTIFIED TO BE COMPUTER GENERATED BY
DUBLIN CITY COUNCIL FROM ORDNANCE SURVEY DIGITAL MAPBASE
SURVEY, MAPPING AND RELATED RESEARCH APPROVED

JOHN W. FLANAGAN
PhD CEng Eur Ing FIEI FICE
ACTING CITY ENGINEER

APPROVED **THOMAS CURRAN**
ACTING MANAGER LAND SURVEYING & MAPPING
DUBLIN CITY COUNCIL

INDEX No.
SM-2015-1019